

comune di
Alessandria

committente
Comune di Alessandria

titolo
Progetto per la realizzazione del "Museo del Cappello Borsalino"
Corso Cento Cannoni n° 21 - Piano terreno
OPERE DI ALLESTIMENTO - DEFINITIVO/ESECUTIVO

il progettista: arch. Riccardo Rovada

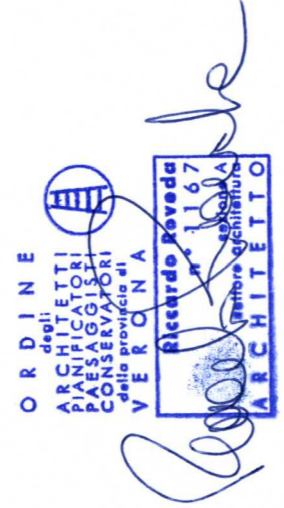

tavola

5

ESECUTIVO OPERE IN APPALTO
indicazione cavi "rossi" per corpi illuminanti

scala









1:50

data

luglio 2018

SCR studio casali roveda
architetti associati
www.studioSCR.it

LEGENDA LUCI

-  SOSPENSIONE SFERA DI RECUPERO (GIÀ POSIZIONATE)
-  SOFFITTO CILINDRO IN FERRO SU DISEGNO
-  SOSPENSIONE CILINDRO IN FERRO SU DISEGNO
-  LED INTERNO MOBILI
-  FIBRA OTTICA DI RECUPERO ALL'INTERNO DEI MOBILI
-  LAMPADA A PAVIMENTO PROFILO TRIANGOLARE A TERRA
-  LAMPADA A PARETE
-  FARETTO AD INCASSO DA CARTONGESSO

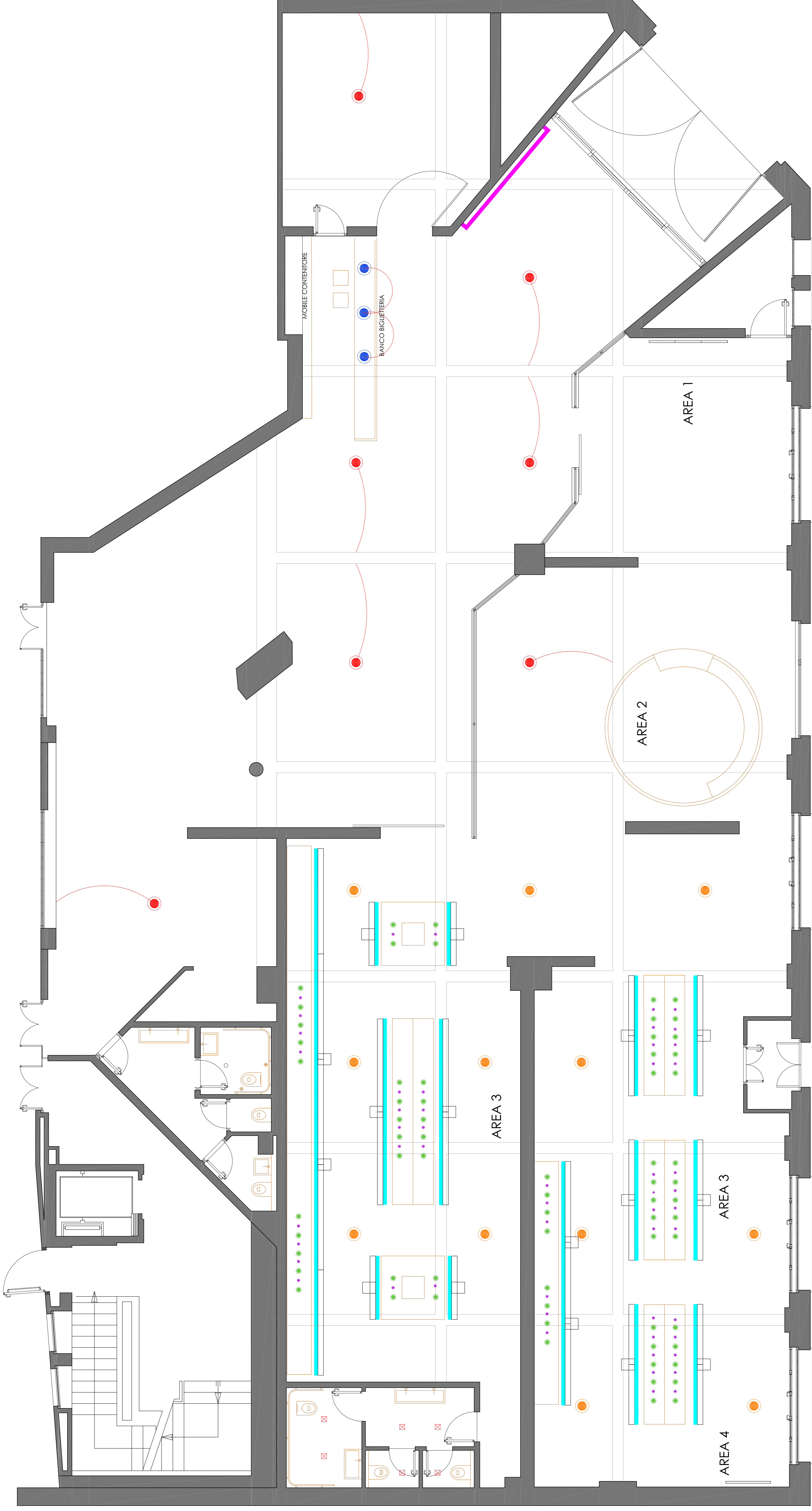

ALLESTIMENTO MUSEO - ILLUMINOTECNICA